

Chief Air Jack

Users Manual





CHIEF'S LIMITED ONE-YEAR WARRANTY & LIABILITY

Chief Automotive Technologies, Inc. warrants for one year from date of installation and/or purchase any of its products which do not perform satisfactorily due to defect caused by faulty material or workmanship. Chief's obligation under this warranty is limited to the repair or replacement of products which are defective and which have not been misused, carelessly handled, or defaced by repair or repairs made or attempted by others.

CHIEF AUTOMOTIVE TECHNOLOGIES, INC. DOES NOT ASSUME RESPONSIBILITY FOR ANY DEATH, INJURY OR PROPERTY DAMAGE RESULTING FROM THE OPERATOR'S NEGLIGENCE OR MISUSE OF THIS PRODUCT OR ITS ATTACHMENTS. CHIEF MAKES NO WRITTEN, EXPRESS OR IMPLIED WARRANTY WHATSOEVER OF MERCHANTABILITY OR FITNESS FOR A PARTICULAR PURPOSE OR OTHERWISE REGARDING THE EQUIPMENT OR ANY PART OF THE PRODUCT OTHER THAN THE LIMITED ONE-YEAR WARRANTY STATED ABOVE.

The Chief AirJack (see Figure 1) is a lightweight lifting tool that is easy to use. The device is ideal for tire and alignment shops, body shops, and service garages that frequently need to elevate the front end, rear end or side of a vehicle for tire removal / installation.

Read all of the instructions and warnings provided before attempting to operate the Chief Air Jack. Also, make sure all personnel who are to use the Chief Air Jack are familiar with its operation.

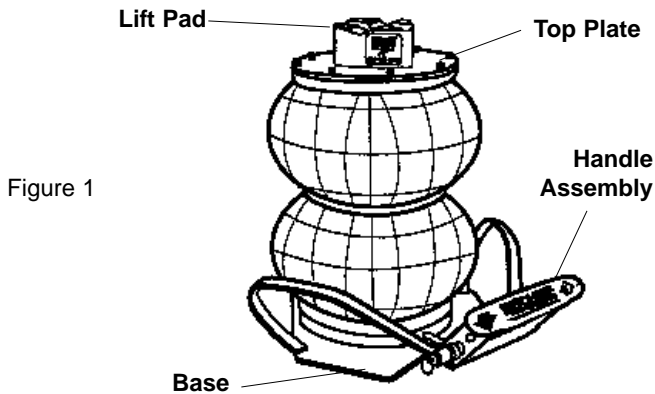

Figure 1

3. Attach air hose to air jack and position jack on solid flat surface directly below structural component to be lifted.

- NOTE:**
- Air inlet on control base handle accepts 1/4 inch NPT fitting. (See Figure 2.) Add a few drops of pneumatic tool oil to air inlet monthly.
 - Position handle assembly for easy access.

WARNING! DO NOT remove brass plug from handle assembly.

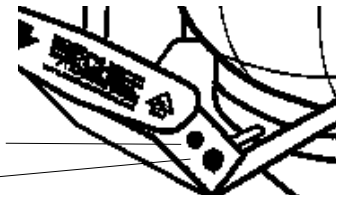

Figure 2

4. Check the intended lifting point on the structural component. This location must be parallel with base of air jack and lift pad. (See Figure 3.) If it is not parallel (see Figure 4), the load may drop suddenly, creating a potential for severe injury or death.

Lifting Point On Structural Component

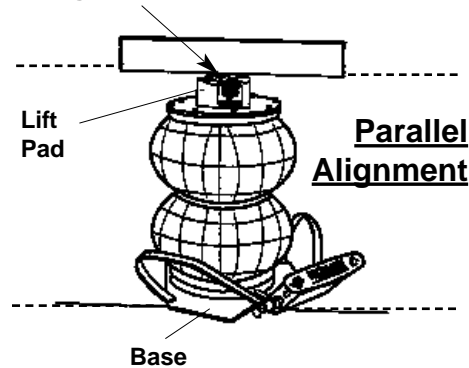

Figure 3



WARNING! To prevent slippage, lifting point on structural component must always be parallel with base of air jack and lift pad.

Lifting Point On Structural Component

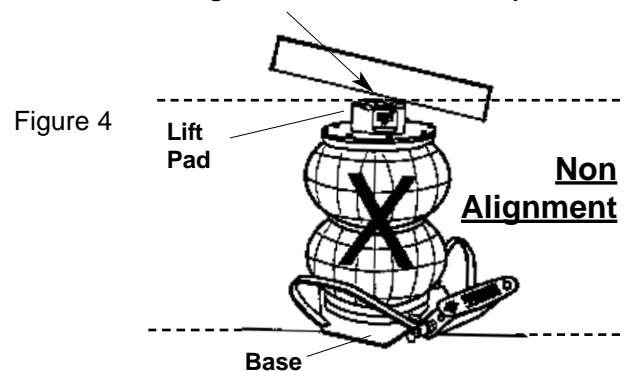

Figure 4

WARNING!

- Visually inspect air jack prior to each use. DO NOT use if scars, abrasions, rips, punctures are detected in the air bag.
- Always wear safety glasses.
- DO NOT use as a jack stand.
- Avoid contact with petroleum based products or chemicals of any kind.
- Use jack stand on firm level surfaces only.
- Avoid sharp objects that may puncture air bag.
- DO NOT use near open flame, sparks, or temperatures exceeding 120° F (49° C).
- Maximum air pressure, 105 PSI (7.24 Bar) .
- Maximum load, 2 ton (1800 kg.)

To operate the Chief air jack:

1. Position vehicle on solid flat surface and engage its parking brake.
2. Block vehicles front and rear wheels.

4. To use the air jack, position both hands on handle assembly. Press 'green' arrow (right side arrow - see Figure 5) and inflate bag slightly to engage lift pad with lifting point on structural component.

WARNING! Lift load from lift pad only. Lifting from top plate will damage air jack and create an unsafe condition.

5. Press 'green' arrow again to elevate structural component to desired height.

WARNING!

- DO NOT lift higher than needed.
- DO NOT over inflate.

6. To deflate the air jack, push the 'red' arrow.

NOTE: If the air hose has been removed from the air jack, press either the 'red' or 'green' arrow to deflate.

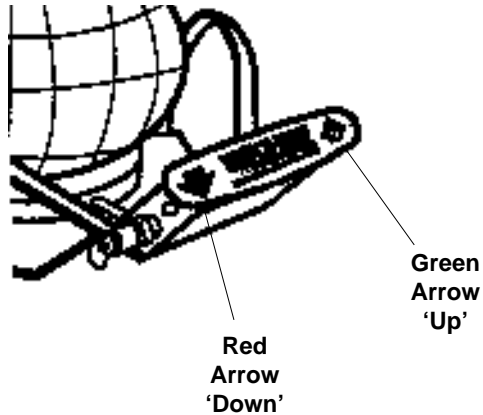
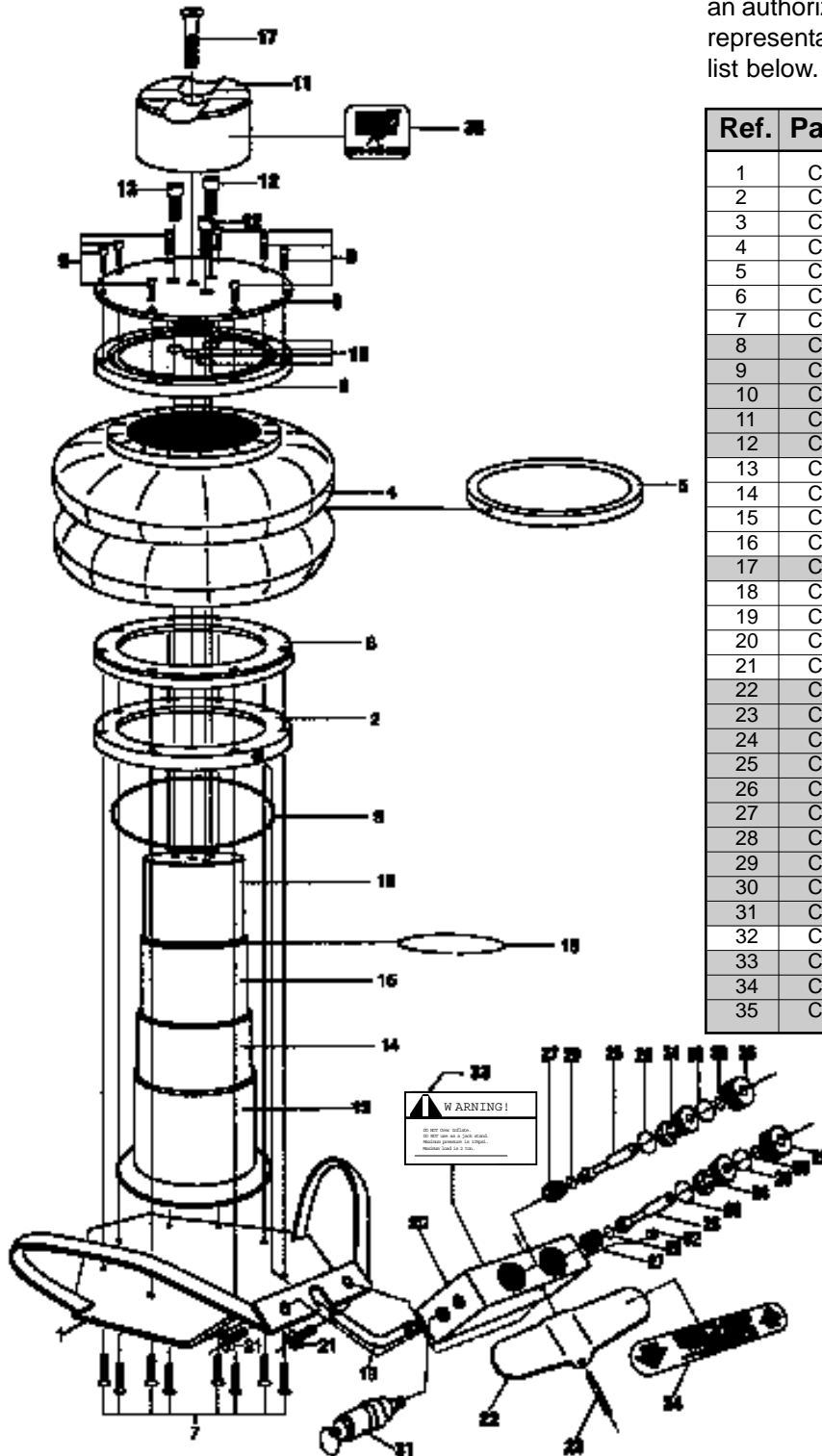

Figure 5

Chief Air Jack

Parts Information

To order replacement parts for the Chief Air Jack, call Chief Automotive Technologies, Inc. 800-445-9262. If located outside the United States, contact an authorized Chief Automotive Technologies, Inc. representative. Refer to parts illustration and parts list below.



Ref.	Part No.	Description
1	CJ2200	Base
2	CJ2201	Lower Air Ring
3	CJ2202	O Ring (Bag Seal) 5.75
4	CJ2203	Air Bag
5	CJ2204	Center ring
6	CJ2205	Upper or Lower Bag Ring
7	CJ2207	Lower Plate Mtg. Bolts 1/4 20 x 1 1/4
8	CJ2208	Top Plate
9	CJ2209	Top Plate Mtg. Bolts 1/4 20 x 3/4
10	CJ2211	Rubber Washers
11	CJ2212	Jack Pad
12	CJ2213	Mtg. Bolts 3/8 16 x 7/8
13	CJ2217	Inner Member No. 1
14	CJ2218	Inner Member No. 2
15	CJ2219	Inner Member No. 3
16	CJ2220	Inner Member No. 4
17	CJ2221	Jack Pad Mtg. Bolt 3/8 16 x 2 1/4
18	CJ2223	Lock Ring
19	CJ2225	Air Filler Tube
20	CJ2226	Valve Block
21	CJ2227	Valve Block Mtg. Bolt 5/16 18 x 5/8
22	CJ2228	Handle
23	CJ2229	Roll Pin 5/16 x .187
24	CJ2230	Valve Body
25	CJ2231	Valve Stem
26	CJ2232	Valve Lock Cap
27	CJ2233	Valve Spring
28	CJ2234	O Ring .625
29	CJ2235	O Ring .250
30	CJ2236	O Ring .3/32 I.D. Teflon
31	CJ2237	Pressure Relief Valve
32	CJ2238	1/8 NPT Brass Allen Plug
33	CJ3101	WARNING Label
34	CJ3102	Chief Label, up / down arrows
35	CJ3103	Chief Label, Logo

Field Replacement Parts in Shaded Areas Only.



**P.O. Box 1368
Grand Island, Nebraska 68802-1368
Phone: 308/384-9747
Fax: 308/384-8966**

www.chiefautomotive.com

**Chief reserves the right to alter product specifications
and/or package components without notice.**